

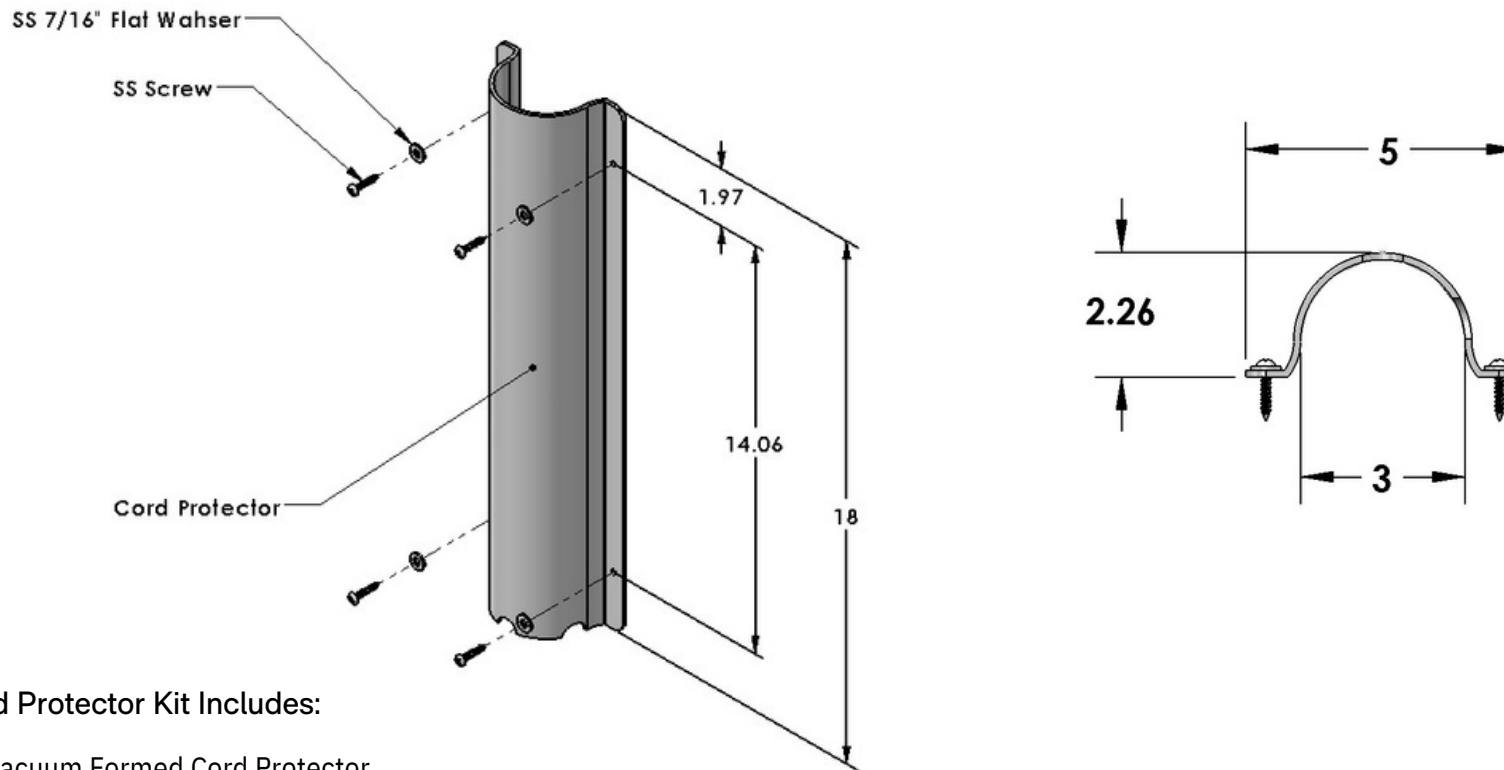

Cord Protector Installation Instructions

The Hog Hearth ABS Cord Protector is designed to protect the connector, conduit and power cable from external damage



The Cord Protector Kit Includes:

- 1 – ABS Vacuum Formed Cord Protector
- 4 – 0.4375" OD x .032" Stainless-Steel Flat Washers
- 4 – ½" Pan Head Stainless Steel Screws

Installation Instructions

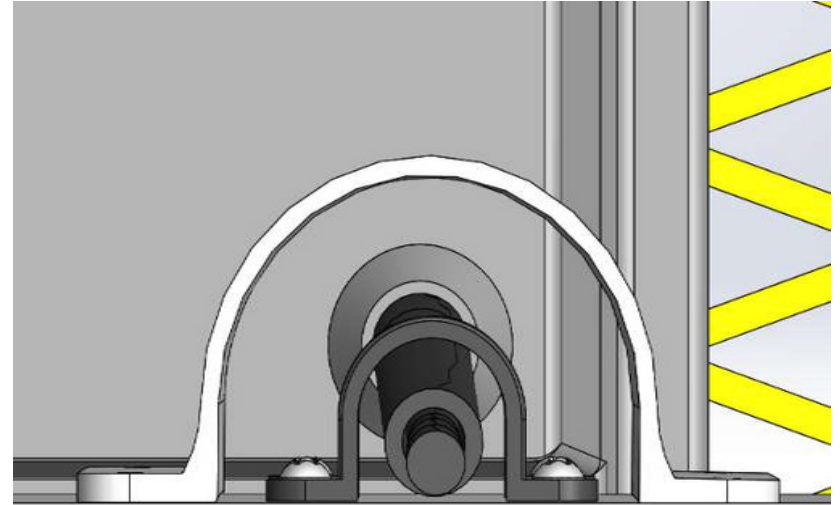
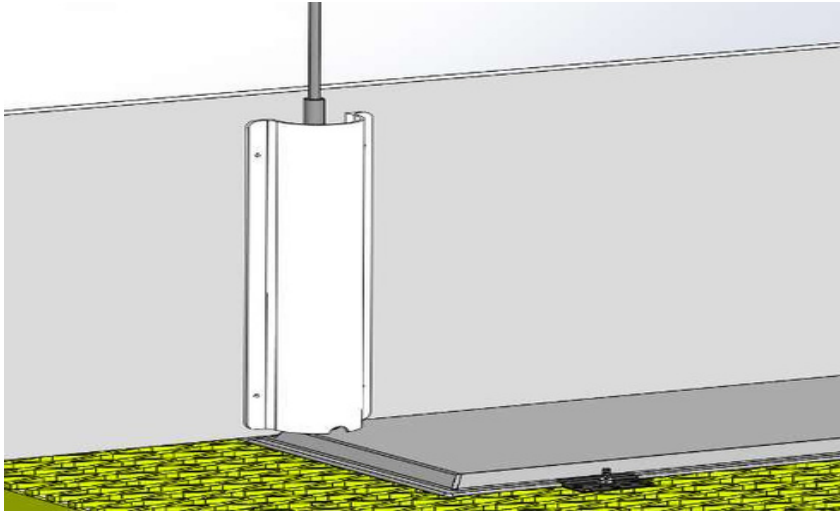

Step 1: Position cord protector over cable / conduit. Be sure to leave equal space on both sides of connector.

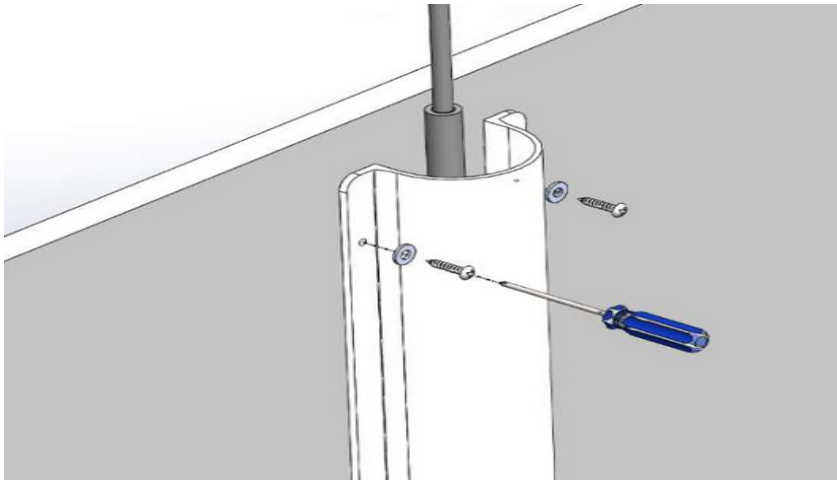

Step 2: Fasten the Cord Protector to the divider using supplied screws / washers.

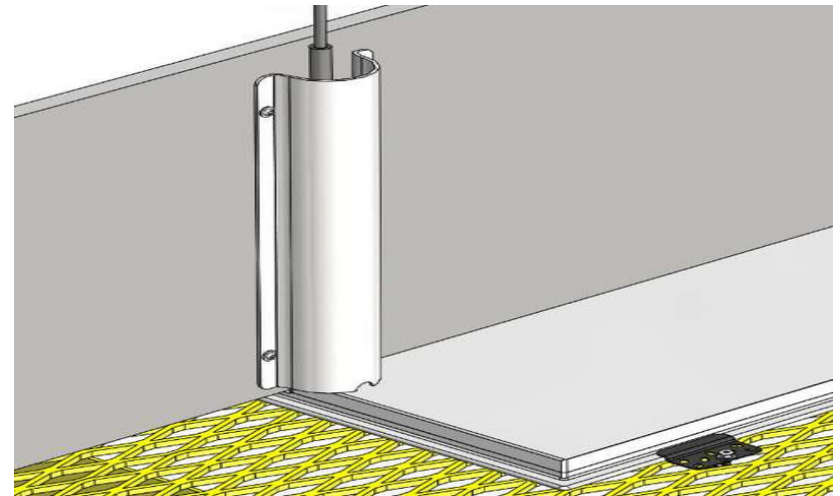

Image of cord protector properly installed